

THIS DOCUMENT, TOGETHER WITH THE CONCEPTS AND DESIGN PRESENTED HEREIN, IS AN INSTRUMENT OF SERVICE. IT IS INTENDED ONLY FOR THE SPECIFIC PURPOSE AND CLIENT FOR WHICH IT WAS PREPARED. REVIEW OF AND MODIFICATIONS TO THIS DOCUMENT WITHOUT WRITTEN AUTHORIZATION AND AGREEMENT BY KIMLEY-HORN AND ASSOCIATES, INC. SHALL BE WITHOUT LIABILITY TO KIMLEY-HORN AND ASSOCIATES, INC.

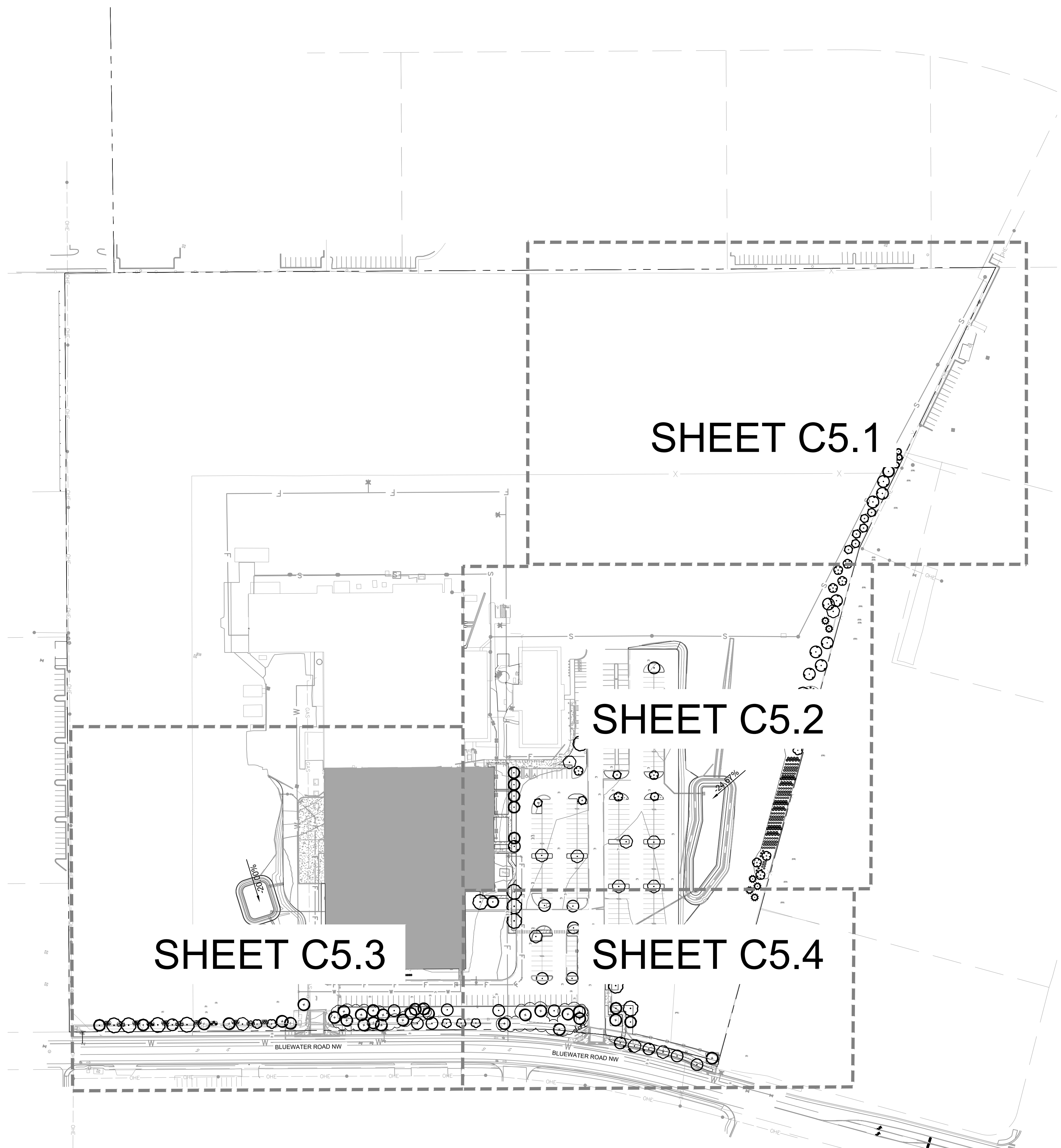

CONSTRUCTION BID NOTES:

1. ALL PLANT SPECIFICATIONS IN THE PLANT SCHEDULE SHALL BE CONSIDERED THE MINIMUM ALLOWABLE SPECIFICATIONS. CONTRACTOR SHALL PROCURE PLANT MATERIALS AND UPSIZE AS NECESSARY TO MEET THE MOST STRINGENT SPECIFICATION.
2. LANDSCAPE ARCHITECT RESERVES THE RIGHT TO FIELD ADJUST ALL PLANT MATERIAL.
3. ALL QUANTITIES PROVIDED FOR CONVENIENCE ONLY. CONTRACTOR SHALL CONFIRM ALL QUANTITIES PER PLAN PRIOR TO BIDDING AND CONSTRUCTION. PLANS TAKE PRECEDENT OVER PLANT SCHEDULE FOR PLANT QUANTITY COUNT.

LANDSCAPE NOTES:

1. TREE CANOPIES AND GROUND-LEVEL PLANS SHALL COVER A MINIMUM OF 75 PERCENT OF THE TOTAL LANDSCAPE AREA AS MEASURED BY CANOPY WIDTH OR THE AREA BENEATH THE DRIPLINE OF THE MATURE SIZE OF THE ACTUAL VEGETATION.
2. NO MORE THAN 10 PERCENT OF REQUIRED LANDSCAPE AREAS SHALL BE TURF GRASS SPECIES REQUIRING IRRIGATION FOR SURVIVAL AFTER THE FIRST 2 GROWING SEASONS.
3. THE USE OF GRAVEL OR CRUSHER FINES AS GROUND COVER IS LIMITED TO A MAXIMUM OF 75 PERCENT OF ANY LANDSCAPED AREA.
4. VEGETATION REQUIRED BY THIS SECTION 14-16-5-6 SHALL BE LOCATED AT LEAST 3 FEET IN ANY DIRECTION FROM ANY FIRE HYDRANTS, VALVE VAULTS, HOSE BIBS, MANHOLES, HYDRANTS, AND FIRE DEPARTMENT CONNECTIONS.
5. TREES SHALL NOT BE PLANTED WITHIN 10 FEET IN ANY DIRECTION OF THE CENTERLINE OF A SEWER OR WATER LINE.
6. IRRIGATION WILL BE PROPOSED FOR THIS SITE AT THE CD PLAN LEVEL.

NO.	REVISION	BY	DATE	APPR.

Kimley»Horn
 © 2023 KIMLEY-HORN AND ASSOCIATES, INC.
 6200 South Syracuse Way, Suite 300
 Greenwood Village, Colorado 80111 (303) 228-2300

DESIGNED BY: ECS
 DRAWN BY: ECS
 CHECKED BY: EWS
 DATE: 4/5/2024

LEGAL DESCRIPTION:
 TRACT A, ATRISCO BUSINESS
 PARK UNIT 1, CONTAINING
 39.775 ACRES

ABB ABQ ADDITION
 6625 BLUEWATER ROAD NW
 SITE PLAN - DFT
 OVERALL LANDSCAPE PLAN

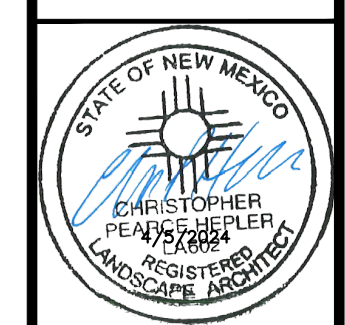

PROJECT NO.
 096523009

SHEET
C5.0

THIS DOCUMENT, TOGETHER WITH THE CONTRACT, AND SPECIFICATIONS PRESENTED HEREIN, IS AN INSTRUMENT OF SERVICE. IT IS INTENDED ONLY FOR THE SPECIFIC PURPOSE AND CLIENT FOR WHICH IT WAS PREPARED. REVIEW OF AND MODIFICATIONS TO THIS DOCUMENT WITHOUT WRITTEN AUTHORIZATION AND ASSUMPTION OF LIABILITY TO KIMLEY-HORN AND ASSOCIATES, INC. SHALL BE WITHOUT LIABILITY TO KIMLEY-HORN AND ASSOCIATES, INC.

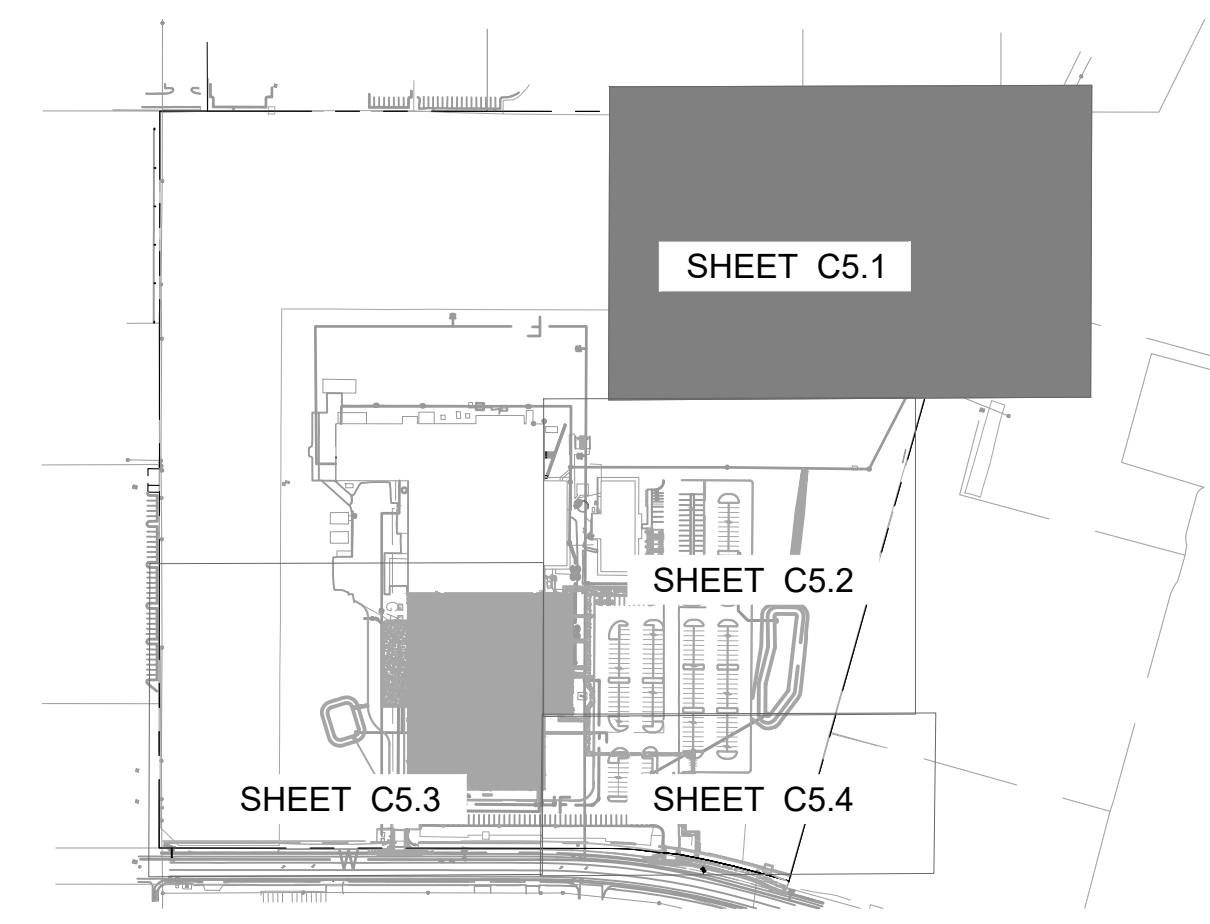
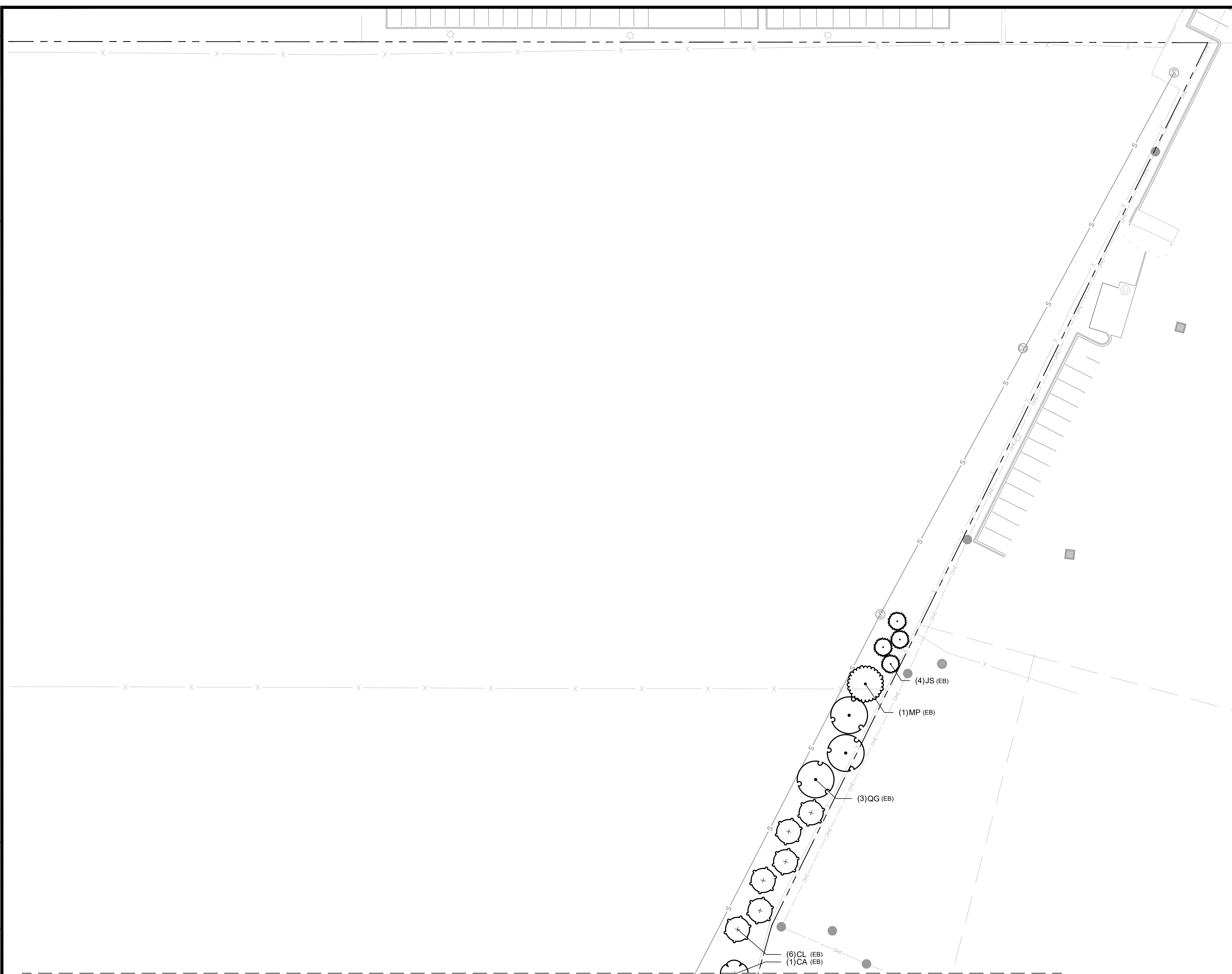

KEY MAP
N.T.S

SYMBOL	CODE	QTY	BUFFER	LANDSCAPE AREA	STREET SCAPE	BOTANICAL NAME	COMMON NAME
GROUND COVERS							
	XL2	8,281 SF		8,281 SF		1-4" AGGREGATE MULCH ROCK	1-4" ANGULAR AGGREGATE MULCH
	XT	4,093 SF		4,093 SF		2-4" AGGREGATE MULCH ROCK	2-4" ANGULAR AGGREGATE MULCH
	RM	57,793 SF	9,350 SF	37,750 SF	10,693 SF	3/4"-1" ROCK MULCH	TO MATCH EXISTING
	XL	24,890 SF		24,890 SF		APPLEWOOD NATIVE SEED MIX	NATIVE SEED MIX
	XA	8,060 SF		8,060 SF		APPLEWOOD SEED MIX	DETENTION SEED MIX

MATCHLINE; SEE SHEET C5.2

- CONSTRUCTION BID NOTES:**
- ALL PLANT SPECIFICATIONS IN THE PLANT SCHEDULE SHALL BE CONSIDERED THE MINIMUM ALLOWABLE SPECIFICATIONS. CONTRACTOR SHALL PROCURE PLANT MATERIALS AND UPSIZE AS NECESSARY TO MEET THE MOST STRINGENT SPECIFICATION.
 - LANDSCAPE ARCHITECT RESERVES THE RIGHT TO FIELD ADJUST ALL PLANT MATERIAL.
 - ALL QUANTITIES PROVIDED FOR CONVENIENCE ONLY. CONTRACTOR SHALL CONFIRM ALL QUANTITIES PER PLAN PRIOR TO BIDDING AND CONSTRUCTION. PLANS TAKE PRECEDENT OVER PLANT SCHEDULE FOR PLANT QUANTITY COUNT.

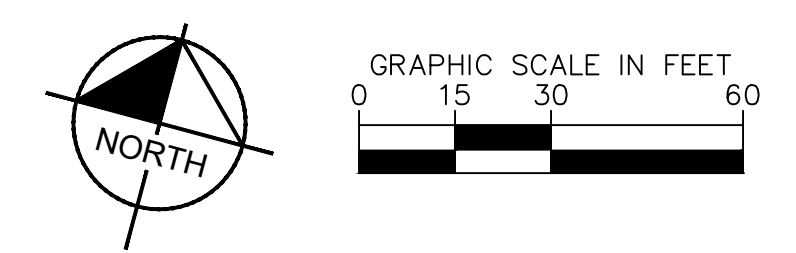

SEE SHEET C5.9 - LANDSCAPE DETAILS FOR COMPLETE PLANT SCHEDULE

NO.	REVISION	BY	DATE	APPR.

Kimley»Horn
© 2023 KIMLEY-HORN AND ASSOCIATES, INC.
6200 South Syracuse Way, Suite 300
Greenwood Village, Colorado 80111 (303) 228-2300

DESIGNED BY: ECS
DRAWN BY: ECS
CHECKED BY: EIWS
DATE: 4/5/2024

LEGAL DESCRIPTION:
TRACT A, TRISCO BUSINESS
PARK UNIT 1 CONTAINING
39.775 ACRES

ABB ABQ ADDITION
6625 BLUEWATER ROAD NW
SITE PLAN - DFT
DETAILED LANDSCAPE PLAN

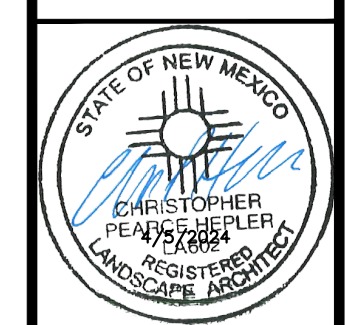

PROJECT NO.
096523009

SHEET
C5.1

THIS DOCUMENT, TOGETHER WITH THE CONTRACT AND REVISIONS, IS INTENDED ONLY FOR THE SPECIFIC PURPOSE AND GENT FOR WHICH IT WAS PREPARED. REVIEW OF AND MODIFICATIONS TO THIS DOCUMENT WITHOUT WRITTEN AUTHORIZATION AND ASSOCIATES, INC. SHALL BE WITHOUT LIABILITY TO KIMLEY-HORN AND ASSOCIATES, INC.

MATCHLINE; SEE SHEET C5.1

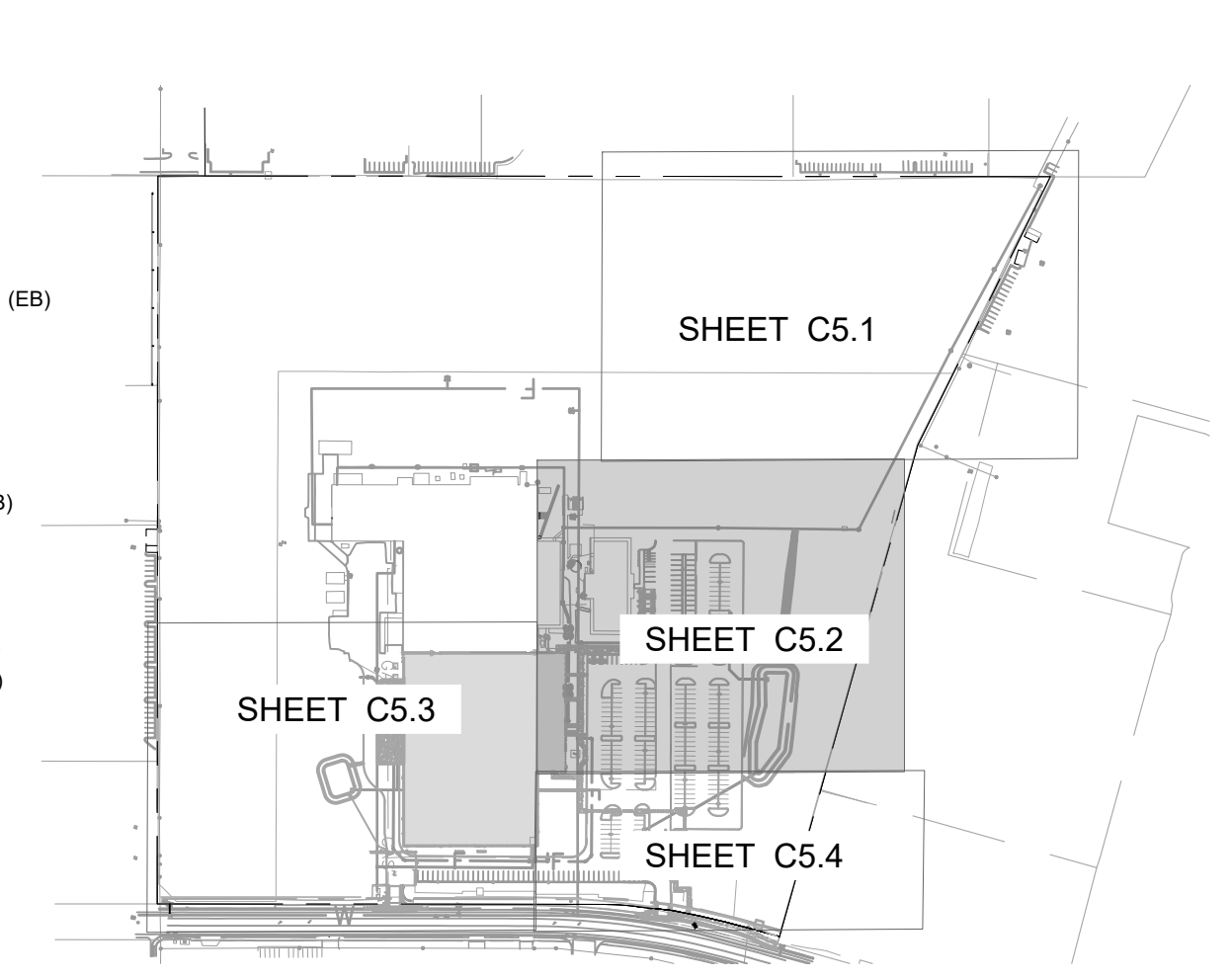
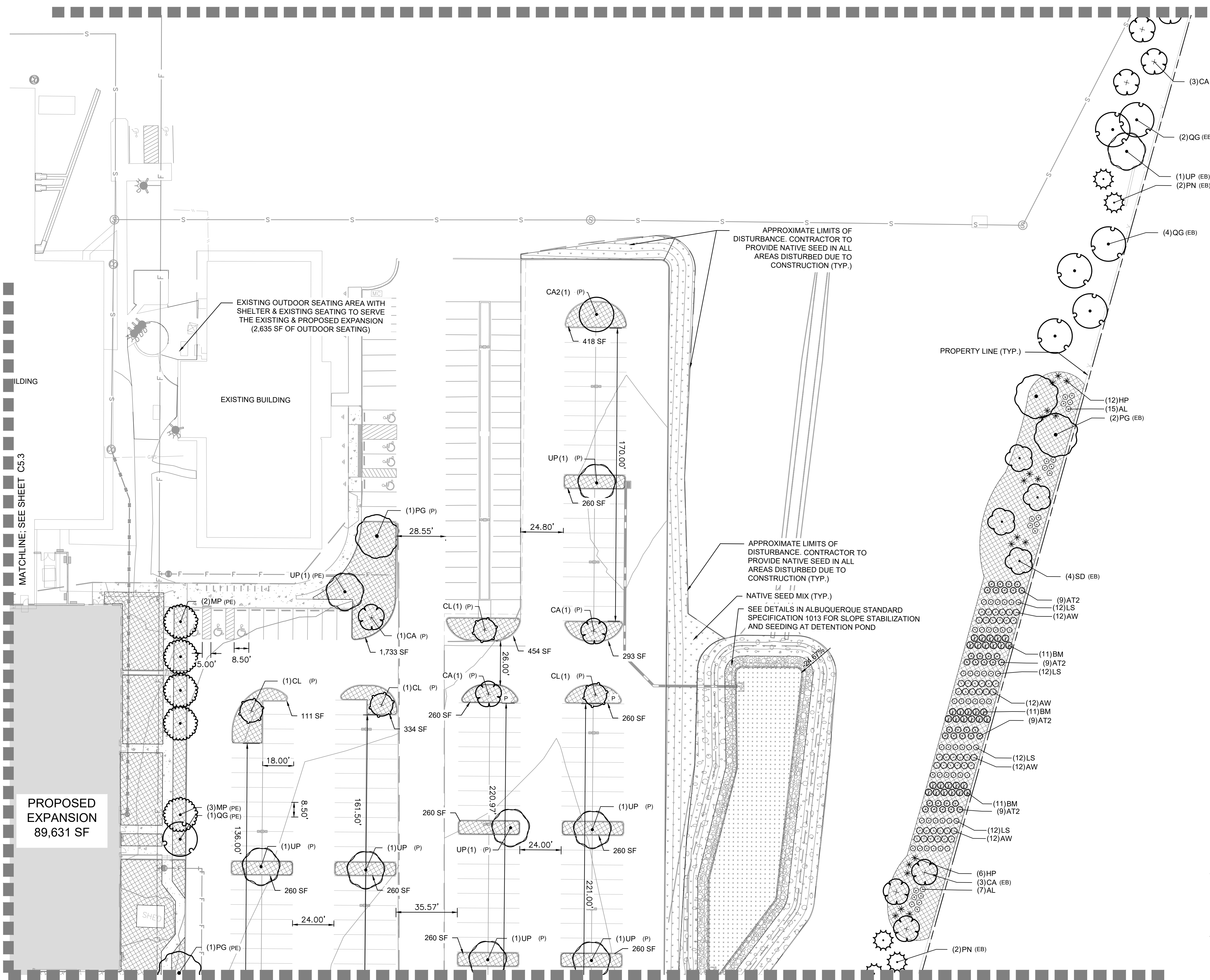

SYMBOL	CODE	QTY	BOTANICAL NAME
	XL2	8,281 SF	1-4" AGGREGATE MULCH ROCK
	XT	4,093 SF	2-4" AGGREGATE MULCH ROCK
	RM	57,793 SF	3/4"-1" ROCK MULCH
	XL	24,890 SF	APPLEWOOD NATIVE SEED MIX
	XA	8,060 SF	APPLEWOOD SEED MIX

SEE SHEET C5.9 - LANDSCAPE DETAILS FOR COMPLETE PLANT SCHEDULE

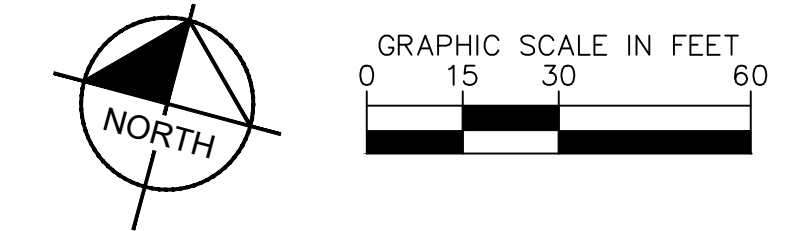

- CONSTRUCTION BID NOTES:**
- ALL PLANT SPECIFICATIONS IN THE PLANT SCHEDULE SHALL BE CONSIDERED THE MINIMUM ALLOWABLE SPECIFICATIONS. CONTRACTOR SHALL PROCURE PLANT MATERIALS AND UPSIZE AS NECESSARY TO MEET THE MOST STRINGENT SPECIFICATION.
 - LANDSCAPE ARCHITECT RESERVES THE RIGHT TO FIELD ADJUST ALL PLANT MATERIAL.
 - ALL QUANTITIES PROVIDED FOR CONVENIENCE ONLY. CONTRACTOR SHALL CONFIRM ALL QUANTITIES PER PLAN PRIOR TO BIDDING AND CONSTRUCTION. PLANS TAKE PRECEDENT OVER PLANT SCHEDULE FOR PLANT QUANTITY COUNT.

- LANDSCAPE NOTES:**
- TREE CANOPIES AND GROUND-LEVEL PLANS SHALL COVER A MINIMUM OF 75 PERCENT OF THE TOTAL LANDSCAPE AREA AS MEASURED BY CANOPY WIDTH OR THE AREA BENEATH THE DRIPLINE OF THE MATURE SIZE OF THE ACTUAL VEGETATION.
 - NO MORE THAN 10 PERCENT OF REQUIRED LANDSCAPE AREAS SHALL BE TURF GRASS SPECIES REQUIRING IRRIGATION FOR SURVIVAL AFTER THE FIRST 2 GROWING SEASONS.
 - THE USE OF GRAVEL OR CRUSHER FINES AS GROUND COVER IS LIMITED TO A MAXIMUM OF 75 PERCENT OF ANY LANDSCAPED AREA.
 - VEGETATION REQUIRED BY THIS SECTION 14-16-5-6 SHALL BE LOCATED AT LEAST 3 FEET IN ANY DIRECTION FROM ANY FIRE HYDRANTS, VALVE VAULTS, HOSE BIBS, MANHOLES, HYDRANTS, AND FIRE DEPARTMENT CONNECTIONS.
 - TREES SHALL NOT BE PLANTED WITHIN 10 FEET IN ANY DIRECTION OF THE CENTERLINE OF A SEWER OR WATER LINE.
 - IRRIGATION WILL BE PROPOSED FOR THIS SITE AT THE CD PLAN LEVEL.

MATCHLINE; SEE SHEET C5.4

NO.	REVISION	BY	DATE	APPR.

Kimley»Horn

© 2023 KIMLEY-HORN AND ASSOCIATES, INC.
6200 South Syracuse Way, Suite 300
Greenwood Village, Colorado 80111 (303) 228-2300

DESIGNED BY: ECS
DRAWN BY: ECS
CHECKED BY: EIWS
DATE: 4/5/2024

LEGAL DESCRIPTION:
TRACT A ATRISCO BUSINESS
PARK UNIT 1 CONTAINING
39.775 ACRES

ABB ABQ ADDITION
6625 BLUEWATER ROAD NW
SITE PLAN - DFT
DETAILED LANDSCAPE PLAN

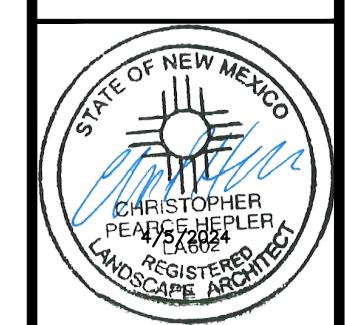

PROJECT NO.
096523009

SHEET
C5.2

THIS DOCUMENT, TOGETHER WITH THE CONTRACT, AND RESONS PRESENTED HEREIN, IS AN INSTRUMENT OF SERVICE. IT IS INTENDED ONLY FOR THE SPECIFIC PURPOSE AND CLIENT FOR WHICH IT WAS PREPARED. REVIEW OF AND WAIVER OF, AND WAIVER OF, RELEASE ON THIS DOCUMENT WITHOUT WRITTEN AUTHORIZATION AND ASSUMPTION OF LIABILITY TO KIMLEY-HORN AND ASSOCIATES, INC. SHALL BE WITHOUT LIABILITY TO KIMLEY-HORN AND ASSOCIATES, INC.

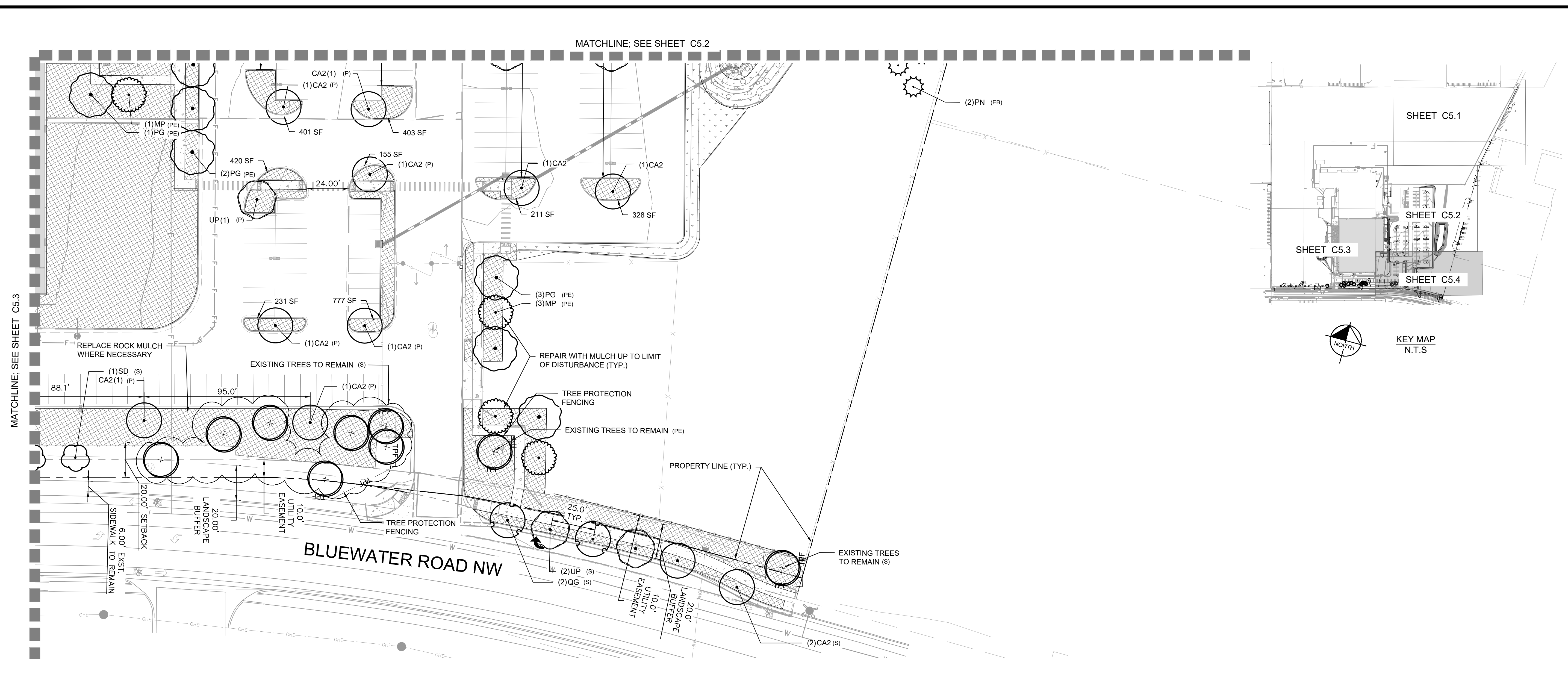

PLANT SCHEDULE LANDSCAPE AREA

SYMBOL	CODE	QTY	BOTANICAL / COMMON NAME
TREES			
	XI	28	EXISTING TREE TO REMAIN
DECIDUOUS TREES			
	CA2	16	CRATAEGUS AMBIGUA RUSSIAN HAWTHORN
	MP	12	MACLURA POMIFERA OSAGE ORANGE
	PG	14	PROSOPIS GLANDULOSA HONEY MESQUITE
	QG	13	QUERCUS GAMBELII GAMBEL OAK
	SD	9	SAPINDUS DRUMMONDII WESTERN SOAPBERRY
	UP	13	ULMUS PARVIFOLIA LACEBARK ELM
EVERGREEN TREES			
	JS	4	JUNIPERUS MONOSPERMA ONESEED JUNIPER
	PN	6	PINUS NIGRA AUSTRIAN PINE

ORNAMENTAL TREES			
	CL	10	CHILOPSIS LINEARIS DESERT WILLOW
	CA	10	CRATAEGUS AMBIGUA RUSSIAN HAWTHORN
SHRUBS			
	AL	22	AMORPHA CANESCENS LEADPLANT
	AW	48	ANISACANTHUS WRIGHTII WRIGHT'S DESERT HONEYSUCKLE
	AT2	36	ARTEMISIA TRIDENTATA BIG SAGEBRUSH
	BM	33	BUDDLEJA MARRUBIFOLIA WOOLLY BUTTERFLY BUSH
	FP	9	FALLUGIA PARADOXA APACHE PLUME
	HP	28	HESPERALOE PARVIFLORA RED YUCCA
	LS	78	LEUCOPHYLLUM FRUTESCENS 'COMPACTA' COMPACT TEXAS RANGER
ORNAMENTAL GRASSES			
	SW	6	SPOROBOLUS WRIGHTII BIG SACATON
GROUND COVERS			
	XL2	8,281 SF	1-4" AGGREGATE MULCH ROCK
	XT	4,093 SF	1-4" ANGULAR AGGREGATE MULCH
	RM	57,793 SF	2-4" AGGREGATE MULCH ROCK
	XL	24,890 SF	2-4" ANGULAR AGGREGATE MULCH
	XA	8,060 SF	3/4"-1" ROCK MULCH TO MATCH EXISTING APPLEWOOD NATIVE SEED MIX NATIVE SEED MIX APPLEWOOD SEED MIX DETENTION SEED MIX

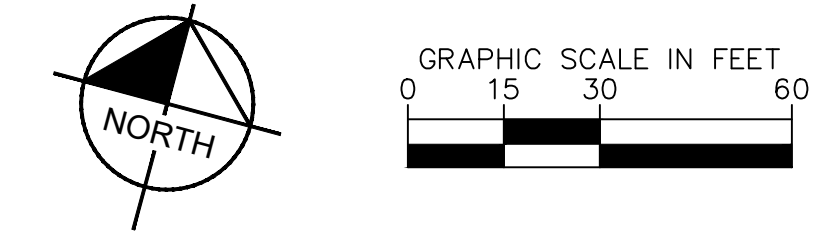

- CONSTRUCTION NOTES:**
- ALL PLANT SPECIFICATIONS IN THE PLANT SCHEDULE SHALL BE CONSIDERED THE MINIMUM ALLOWABLE SPECIFICATIONS. CONTRACTOR SHALL PROCURE PLANT MATERIALS AND UPSIZE AS NECESSARY TO MEET THE MOST STRINGENT SPECIFICATION.
 - LANDSCAPE ARCHITECT RESERVES THE RIGHT TO FIELD ADJUST ALL PLANT MATERIAL.
 - ALL QUANTITIES PROVIDED FOR CONVENIENCE ONLY. CONTRACTOR SHALL CONFIRM ALL QUANTITIES PER PLAN PRIOR TO BIDDING AND CONSTRUCTION. PLANS TAKE PRECEDENT OVER PLANT SCHEDULE FOR PLANT QUANTITY COUNT.
- LANDSCAPE NOTES:**
- TREE CANOPIES AND GROUND-LEVEL PLANS SHALL COVER A MINIMUM OF 75 PERCENT OF THE TOTAL LANDSCAPE AREA AS MEASURED BY CANOPY WIDTH OR THE AREA BENEATH THE DRIPLINE OF THE MATURE SIZE OF THE ACTUAL VEGETATION.
 - NO MORE THAN 10 PERCENT OF REQUIRED LANDSCAPE AREAS SHALL BE TURF GRASS SPECIES REQUIRING IRRIGATION FOR SURVIVAL AFTER THE FIRST 2 GROWING SEASONS.
 - THE USE OF GRAVEL OR CRUSHER FINES AS GROUND COVER IS LIMITED TO A MAXIMUM OF 75 PERCENT OF ANY LANDSCAPED AREA.
 - VEGETATION REQUIRED BY THIS SECTION 14-16-5-6 SHALL BE LOCATED AT LEAST 3 FEET IN ANY DIRECTION FROM ANY FIRE HYDRANTS, VALVE VAULTS, HOSE BIBS, MANHOLES, HYDRANTS, AND FIRE DEPARTMENT CONNECTIONS.
 - TREES SHALL NOT BE PLANTED WITHIN 10 FEET IN ANY DIRECTION OF THE CENTERLINE OF A SEWER OR WATER LINE.
 - IRRIGATION WILL BE PROPOSED FOR THIS SITE AT THE CD PLAN LEVEL.

ABB ABQ ADDITION
6625 BLUEWATER ROAD NW
SITE PLAN - DFT
DETAILED LANDSCAPE PLAN

© 2023 KIMLEY-HORN AND ASSOCIATES, INC.
6200 South Syracuse Way, Suite 300
Greenwood Village, Colorado 80111 (303) 228-2300

DESIGNED BY: ECS
DRAWN BY: ECS
CHECKED BY: EWS
DATE: 4/5/2024

NO.	REVISION	BY	DATE	APPR.

LEGAL DESCRIPTION:
TRACT A ATRISCO BUSINESS
PARK UNIT 1 CONTAINING
39.775 ACRES

PROJECT NO.
096523009

SHEET
C5.4

THIS DOCUMENT, TOGETHER WITH THE CONTRACT, AND DESIGN PRESENTED HEREIN, IS AN INSTRUMENT OF SERVICE. IT IS INTENDED ONLY FOR THE SPECIFIC PURPOSE AND CLIENT FOR WHICH IT WAS PREPARED. REVIEW OF AND MODIFICATIONS TO THIS DOCUMENT WITHOUT WRITTEN AUTHORIZATION AND AGREEMENT BY THE CLIENT SHALL BE WITHOUT LIABILITY TO KIMLEY-HORN AND ASSOCIATES, INC.

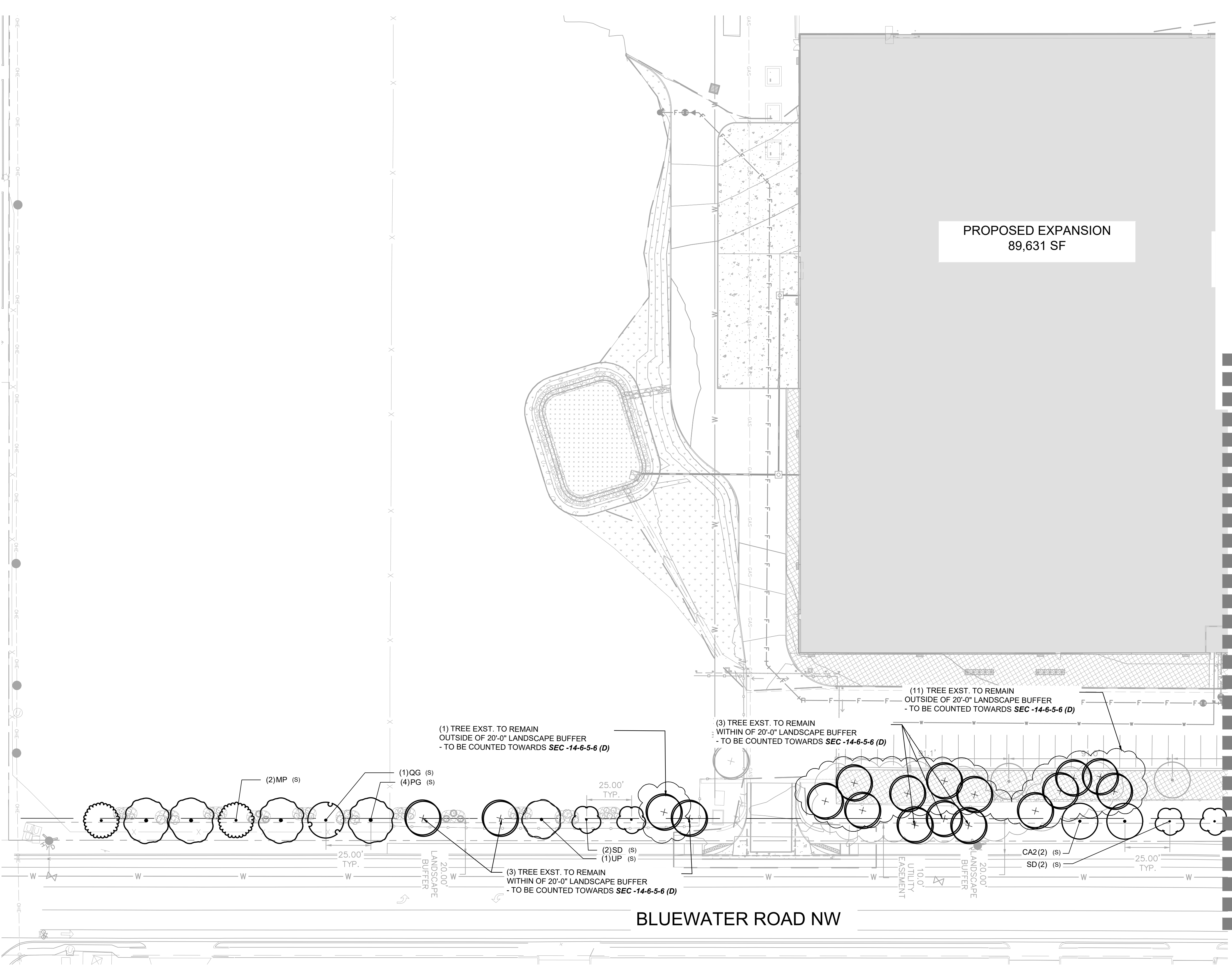

PROPOSED EXPANSION
89,631 SF

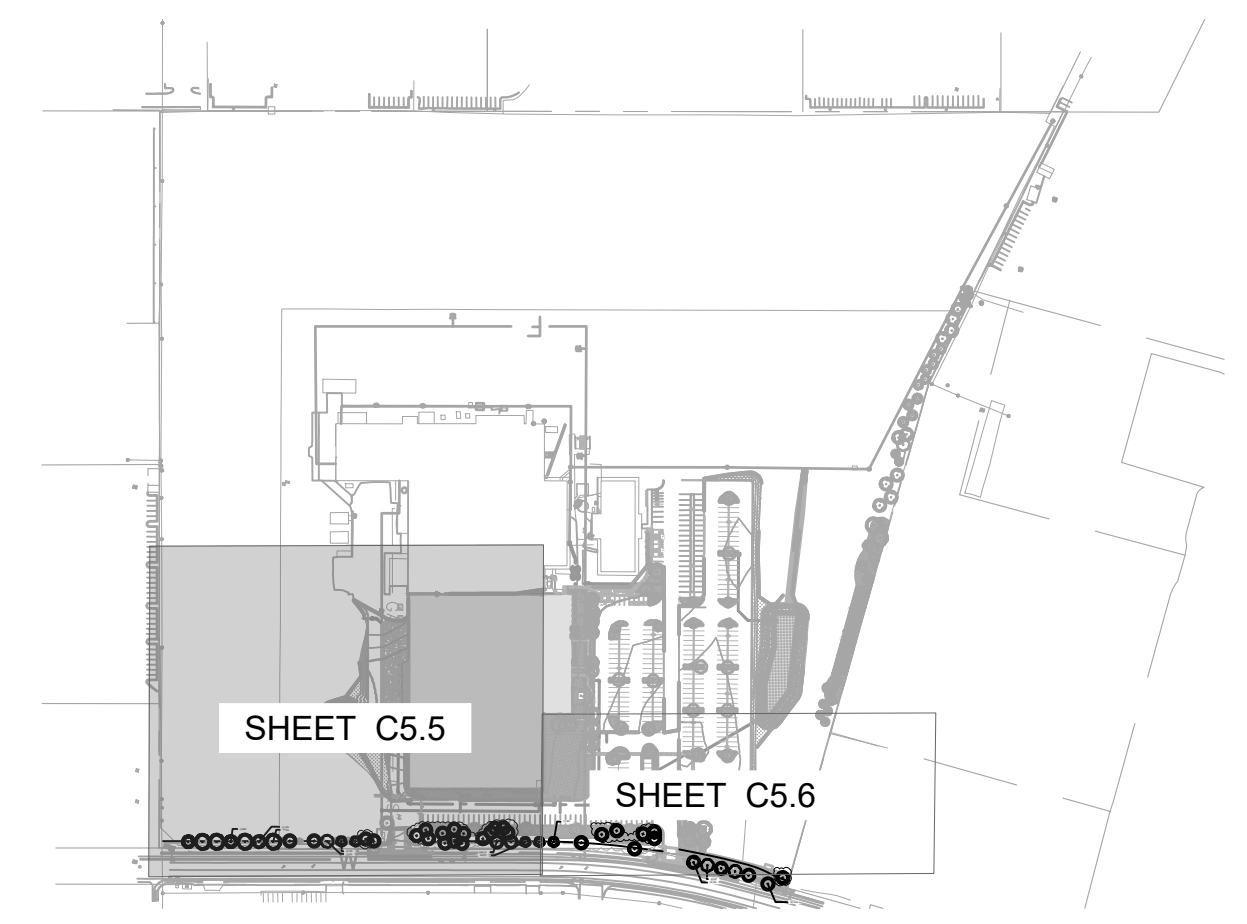

KEY MAP
N.T.S.

ALTERNATE LANDSCAPE
STREET FRONTAGE 14-6-5-6(D)

1 TREE / 25 LF OF STREET FRONTAGE REQUIRED =	45 TREES
TOTAL TREES PROPOSED	21 TREES
TOTAL EXISTING TREES TO REMAIN FOR STREET FRONTAGE REQ.	26 TREES
EXISTING TREES WITHIN 20'-0" LANDSCAPE BUFFER	8 TREES
EXISTING TREES OUTSIDE 20'-0" LANDSCAPE BUFFER	18 TREES
TOTAL TREES PROVIDED (EXISTING AND PROPOSED)	47 TREES

MATCHLINE: SEE SHEET C5.6

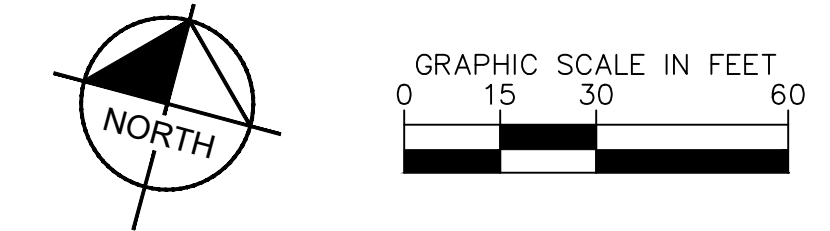

- CONSTRUCTION BID NOTES:**
- ALL PLANT SPECIFICATIONS IN THE PLANT SCHEDULE SHALL BE CONSIDERED THE MINIMUM ALLOWABLE SPECIFICATIONS. CONTRACTOR SHALL PROCURE PLANT MATERIALS AND UPSIZE AS NECESSARY TO MEET THE MOST STRINGENT SPECIFICATION.
 - LANDSCAPE ARCHITECT RESERVES THE RIGHT TO FIELD ADJUST ALL PLANT MATERIAL.
 - ALL QUANTITIES PROVIDED FOR CONVENIENCE ONLY. CONTRACTOR SHALL CONFIRM ALL QUANTITIES PER PLAN PRIOR TO BIDDING AND CONSTRUCTION. PLANS TAKE PRECEDENT OVER PLANT SCHEDULE FOR PLANT QUANTITY COUNT.

- LANDSCAPE NOTES:**
- TREE CANOPIES AND GROUND-LEVEL PLANS SHALL COVER A MINIMUM OF 75 PERCENT OF THE TOTAL LANDSCAPE AREA AS MEASURED BY CANOPY WIDTH OR THE AREA BENEATH THE DRIPLINE OF THE MATURE SIZE OF THE ACTUAL VEGETATION.
 - NO MORE THAN 10 PERCENT OF REQUIRED LANDSCAPE AREAS SHALL BE TURF GRASS SPECIES REQUIRING IRRIGATION FOR SURVIVAL AFTER THE FIRST 2 GROWING SEASONS.
 - THE USE OF GRAVEL OR CRUSHER FINES AS GROUND COVER IS LIMITED TO A MAXIMUM OF 75 PERCENT OF ANY LANDSCAPED AREA.
 - VEGETATION REQUIRED BY THIS SECTION 14-16-5-6 SHALL BE LOCATED AT LEAST 3 FEET IN ANY DIRECTION FROM ANY FIRE HYDRANTS, VALVE VAULTS, HOSE BIBS, MANHOLES, HYDRANTS, AND FIRE DEPARTMENT CONNECTIONS.
 - TREES SHALL NOT BE PLANTED WITHIN 10 FEET IN ANY DIRECTION OF THE CENTERLINE OF A SEWER OR WATER LINE.
 - IRRIGATION WILL BE PROPOSED FOR THIS SITE AT THE CD PLAN LEVEL.

NO.	REVISION	BY	DATE	APPR.

Kimley»Horn
© 2023 KIMLEY-HORN AND ASSOCIATES, INC.
6200 South Syracuse Way, Suite 300
Greenwood Village, Colorado 80111 (303) 228-2300

DESIGNED BY: ECS
DRAWN BY: ECS
CHECKED BY: EIWS
DATE: 4/5/2024

LEGAL DESCRIPTION:
TRACT A, ATRISCO BUSINESS
PARK, UNIT 1, CONTAINING
39.775 ACRES

ABB ABQ ADDITION
6625 BLUEWATER ROAD NW
SITE PLAN - DFT
ALTERNATE LANDSCAPE PLAN

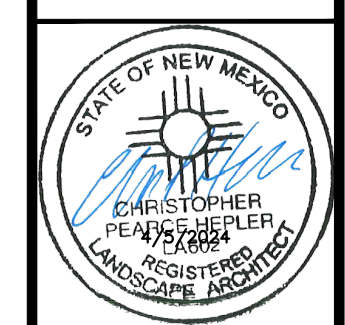

PROJECT NO.
096523009

SHEET
C5.5

THIS DOCUMENT, TOGETHER WITH THE CONTRACT, AND REVISIONS PRESENTED HEREIN, IS AN INSTRUMENT OF SERVICE. IT IS INTENDED ONLY FOR THE SPECIFIC PURPOSE AND CLIENT FOR WHICH IT WAS PREPARED. REVIEW OF AND HARDSHIP, RELIANCE ON THIS DOCUMENT WITHOUT WRITTEN AUTHORIZATION AND ASSOCIATES, INC. SHALL BE WITHOUT LIABILITY TO KIMLEY-HORN AND ASSOCIATES, INC.

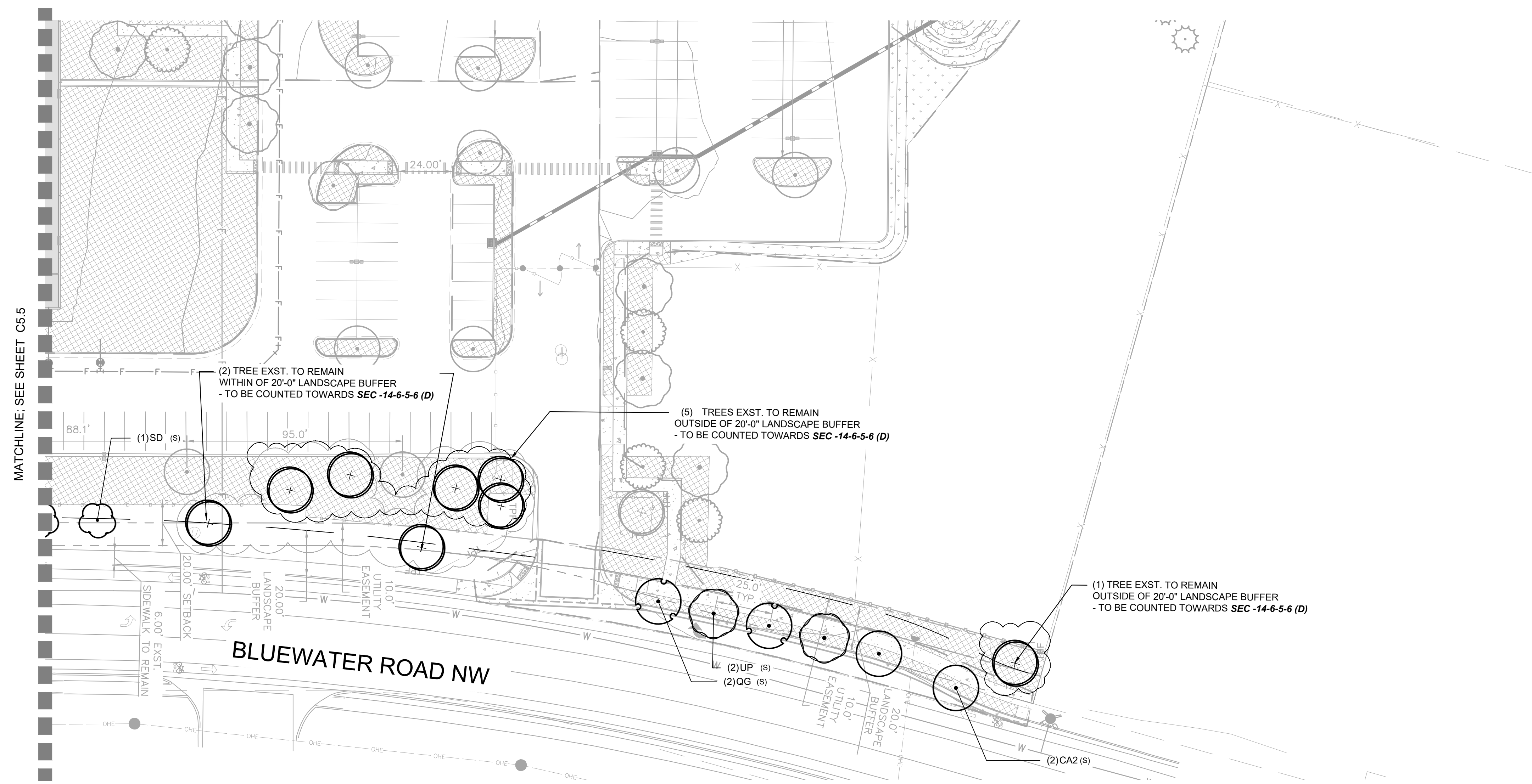

MATCHLINE: SEE SHEET C5.5

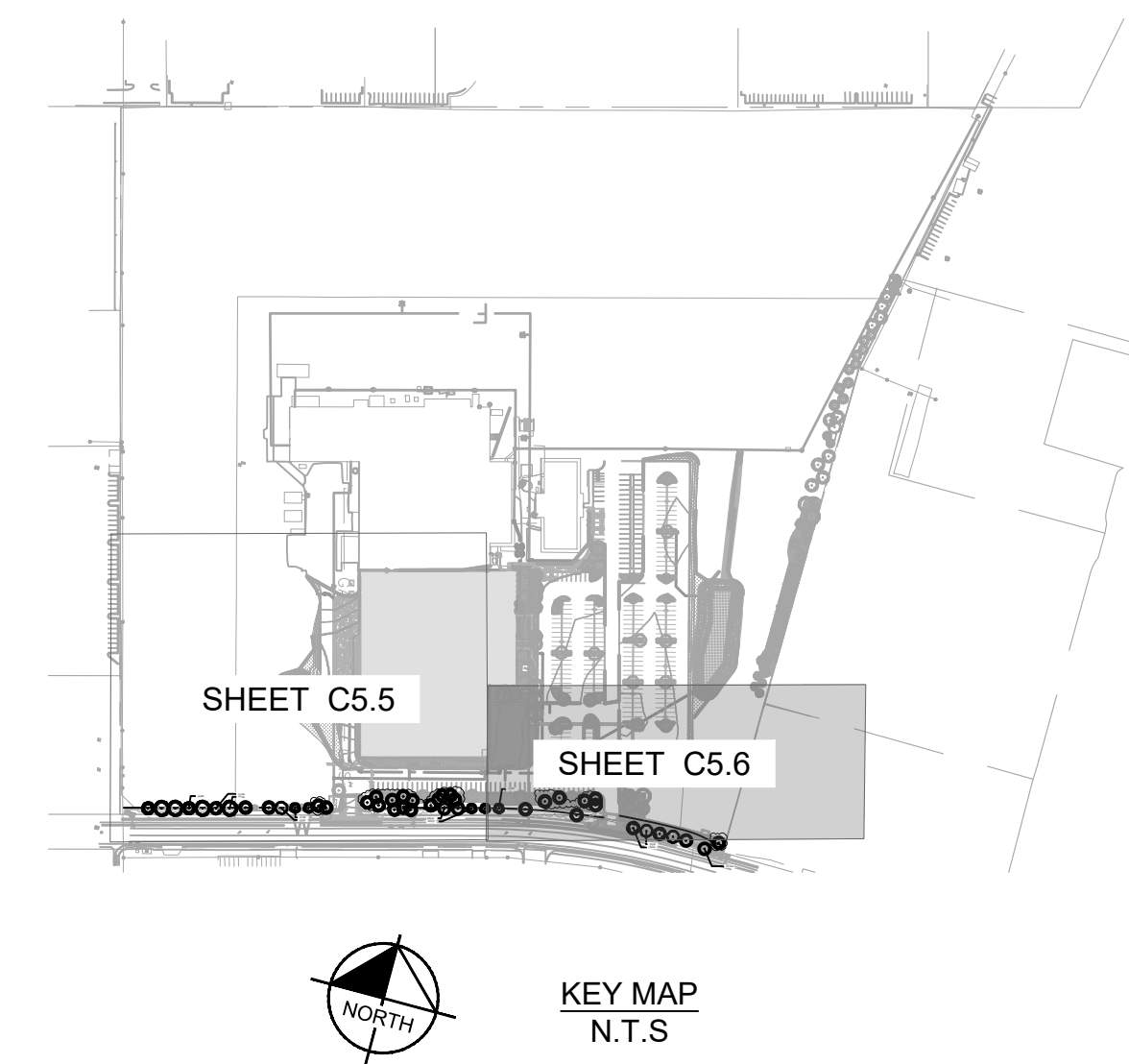

ALTERNATE LANDSCAPE
STREET FRONTAGE 14-6-5-6(D)

1 TREE / 25 LF OF STREET FRONTAGE REQUIRED =	45 TREES
TOTAL TREES PROPOSED	21 TREES
TOTAL EXISTING TREES TO REMAIN FOR STREET FRONTAGE REQ.	26 TREES
EXISTING TREES WITHIN 20'-0" LANDSCAPE BUFFER	8 TREES
EXISTING TREES OUTSIDE 20'-0" LANDSCAPE BUFFER	18 TREES
TOTAL TREES PROVIDED (EXISTING AND PROPOSED)	47 TREES

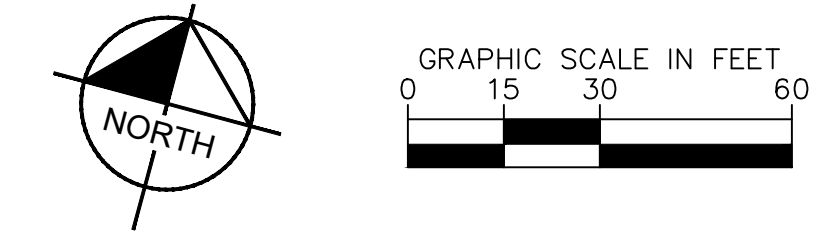

- CONSTRUCTION BID NOTES:**
- ALL PLANT SPECIFICATIONS IN THE PLANT SCHEDULE SHALL BE CONSIDERED THE MINIMUM ALLOWABLE SPECIFICATIONS. CONTRACTOR SHALL PROCURE PLANT MATERIALS AND UPSIZE AS NECESSARY TO MEET THE MOST STRINGENT SPECIFICATION.
 - LANDSCAPE ARCHITECT RESERVES THE RIGHT TO FIELD ADJUST ALL PLANT MATERIAL.
 - ALL QUANTITIES PROVIDED FOR CONVENIENCE ONLY. CONTRACTOR SHALL CONFIRM ALL QUANTITIES PER PLAN PRIOR TO BIDDING AND CONSTRUCTION. PLANS TAKE PRECEDENT OVER PLANT SCHEDULE FOR PLANT QUANTITY COUNT.
- LANDSCAPE NOTES:**
- TREE CANOPIES AND GROUND-LEVEL PLANS SHALL COVER A MINIMUM OF 75 PERCENT OF THE TOTAL LANDSCAPE AREA AS MEASURED BY CANOPY WIDTH OR THE AREA BENEATH THE DRIPLINE OF THE MATURE SIZE OF THE ACTUAL VEGETATION.
 - NO MORE THAN 10 PERCENT OF REQUIRED LANDSCAPE AREAS SHALL BE TURF GRASS SPECIES REQUIRING IRRIGATION FOR SURVIVAL AFTER THE FIRST 2 GROWING SEASONS.
 - THE USE OF GRAVEL OR CRUSHER FINES AS GROUND COVER IS LIMITED TO A MAXIMUM OF 75 PERCENT OF ANY LANDSCAPED AREA.
 - VEGETATION REQUIRED BY THIS SECTION 14-16-5-6 SHALL BE LOCATED AT LEAST 3 FEET IN ANY DIRECTION FROM ANY FIRE HYDRANTS, VALVE VAULTS, HOSE BIBS, MANHOLES, HYDRANTS, AND FIRE DEPARTMENT CONNECTIONS.
 - TREES SHALL NOT BE PLANTED WITHIN 10 FEET IN ANY DIRECTION OF THE CENTERLINE OF A SEWER OR WATER LINE.
 - IRRIGATION WILL BE PROPOSED FOR THIS SITE AT THE CD PLAN LEVEL.

NO.	REVISION	BY	DATE	APPR.

Kimley»Horn
© 2023 KIMLEY-HORN AND ASSOCIATES, INC.
6200 South Syracuse Way, Suite 300
Greenwood Village, Colorado 80111 (303) 228-2300

DESIGNED BY: ECS
DRAWN BY: ECS
CHECKED BY: EIWS
DATE: 4/5/2024

LEGAL DESCRIPTION:
TRACT A ATRISCO BUSINESS
PARK UNIT 1 CONTAINING
39.775 ACRES

ABB ABQ ADDITION
6625 BLUEWATER ROAD NW
SITE PLAN - DFT
ALTERNATE LANDSCAPE PLAN

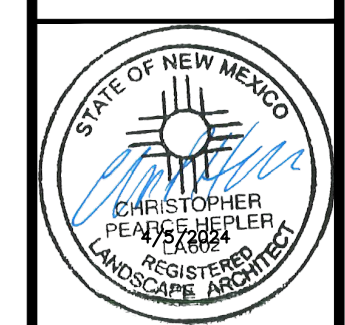

PROJECT NO.
096523009

SHEET
C5.6

THIS DOCUMENT, TOGETHER WITH THE CONTRACT, IS INTENDED ONLY FOR THE SPECIFIC PURPOSE AND GENT FOR WHICH IT WAS PREPARED. REVIEW OF AND MODIFICATIONS TO THIS DOCUMENT WITHOUT WRITTEN AUTHORIZATION AND AGREEMENT BY KIMLEY-HORN AND ASSOCIATES, INC. SHALL BE WITHOUT LIABILITY TO KIMLEY-HORN AND ASSOCIATES, INC.

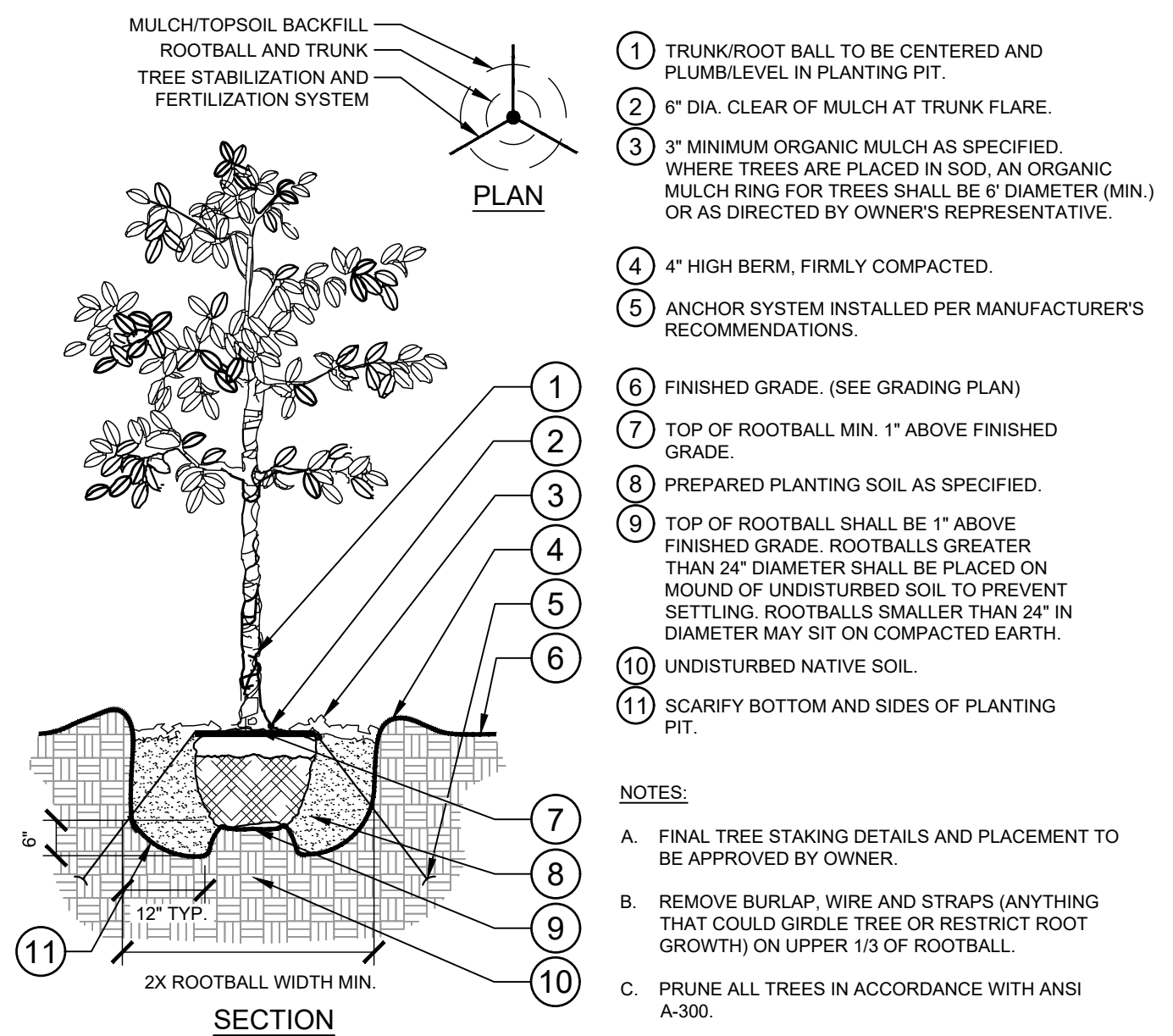

1 TREE PLANTING
SECTION / PLAN
NTS

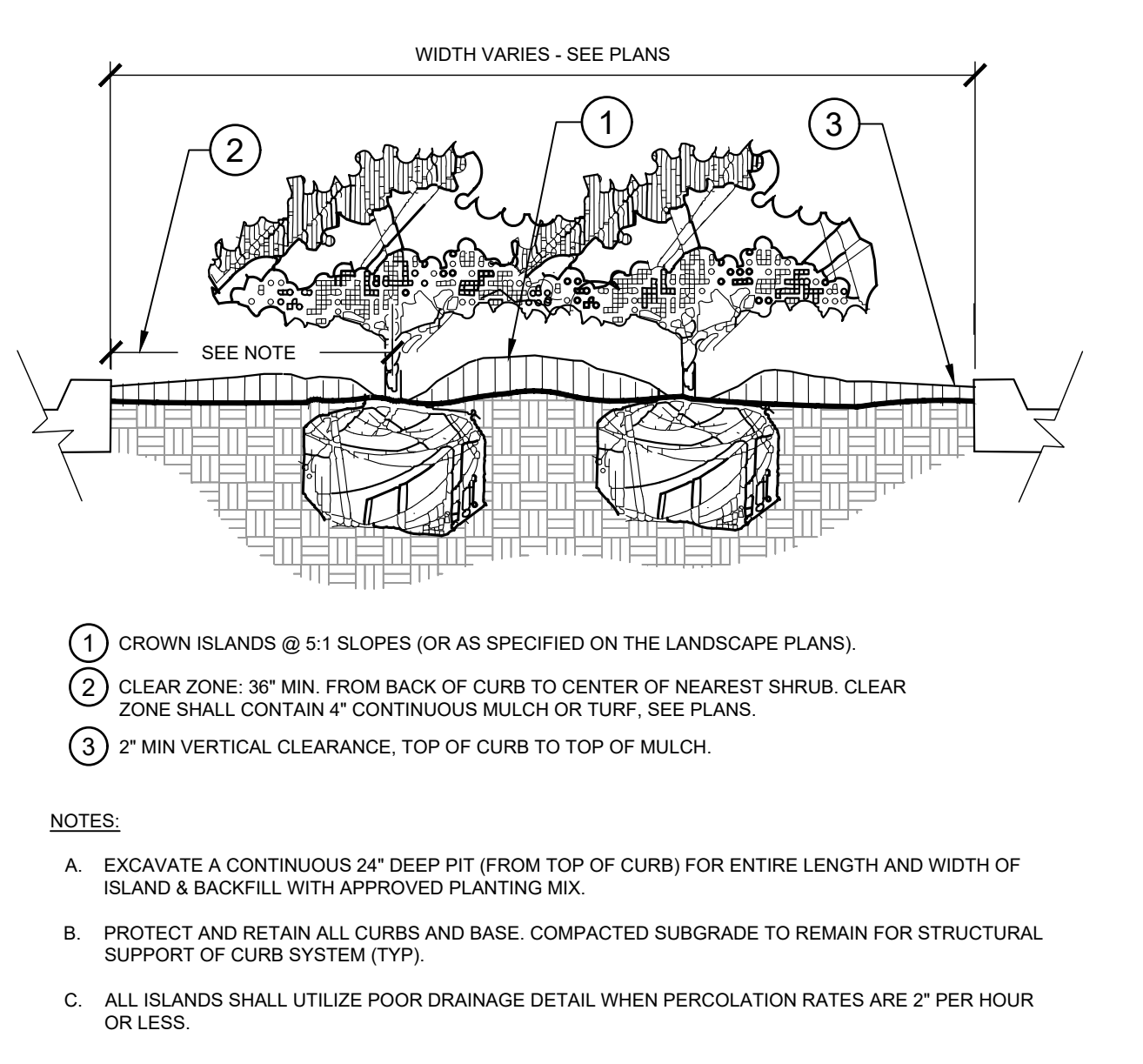

2 PLANTED PARKING LOT ISLANDS/MEDIANS
SECTION
NTS

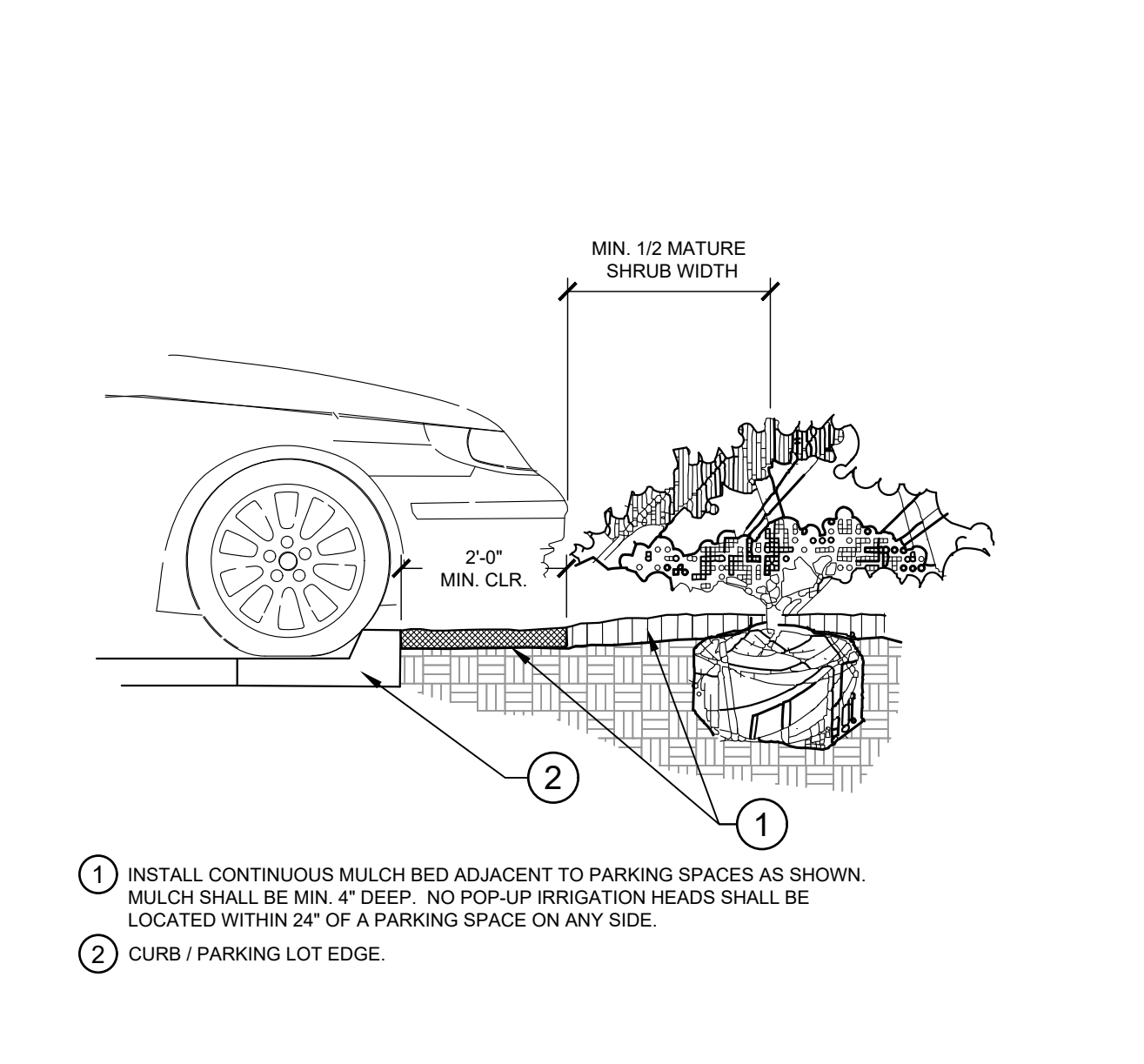

3 PARKING SPACE/CURB PLANTING
SECTION
NTS

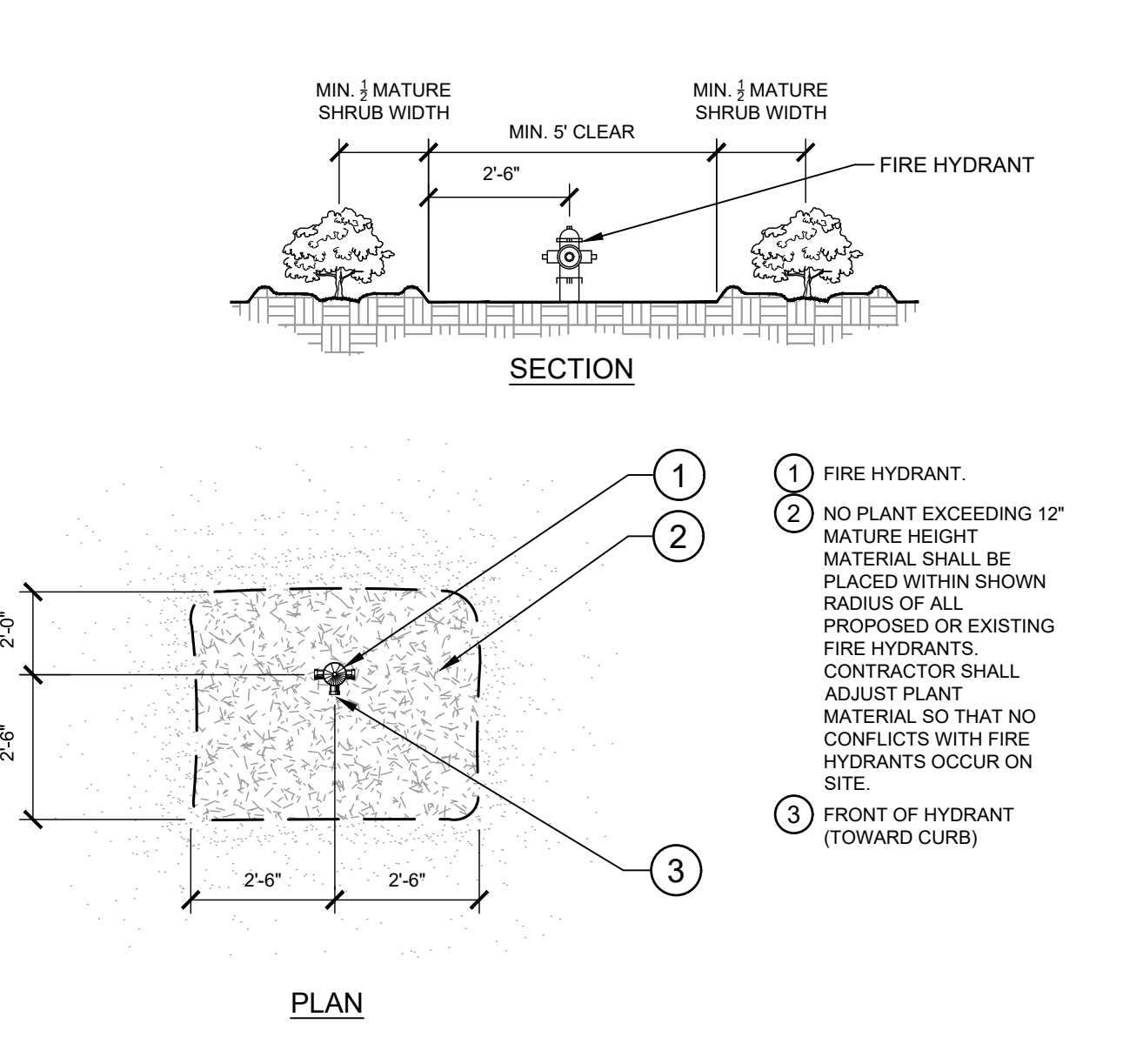

4 SHRUB PLANTING AT FIRE HYDRANT
SECTION / PLAN
NTS

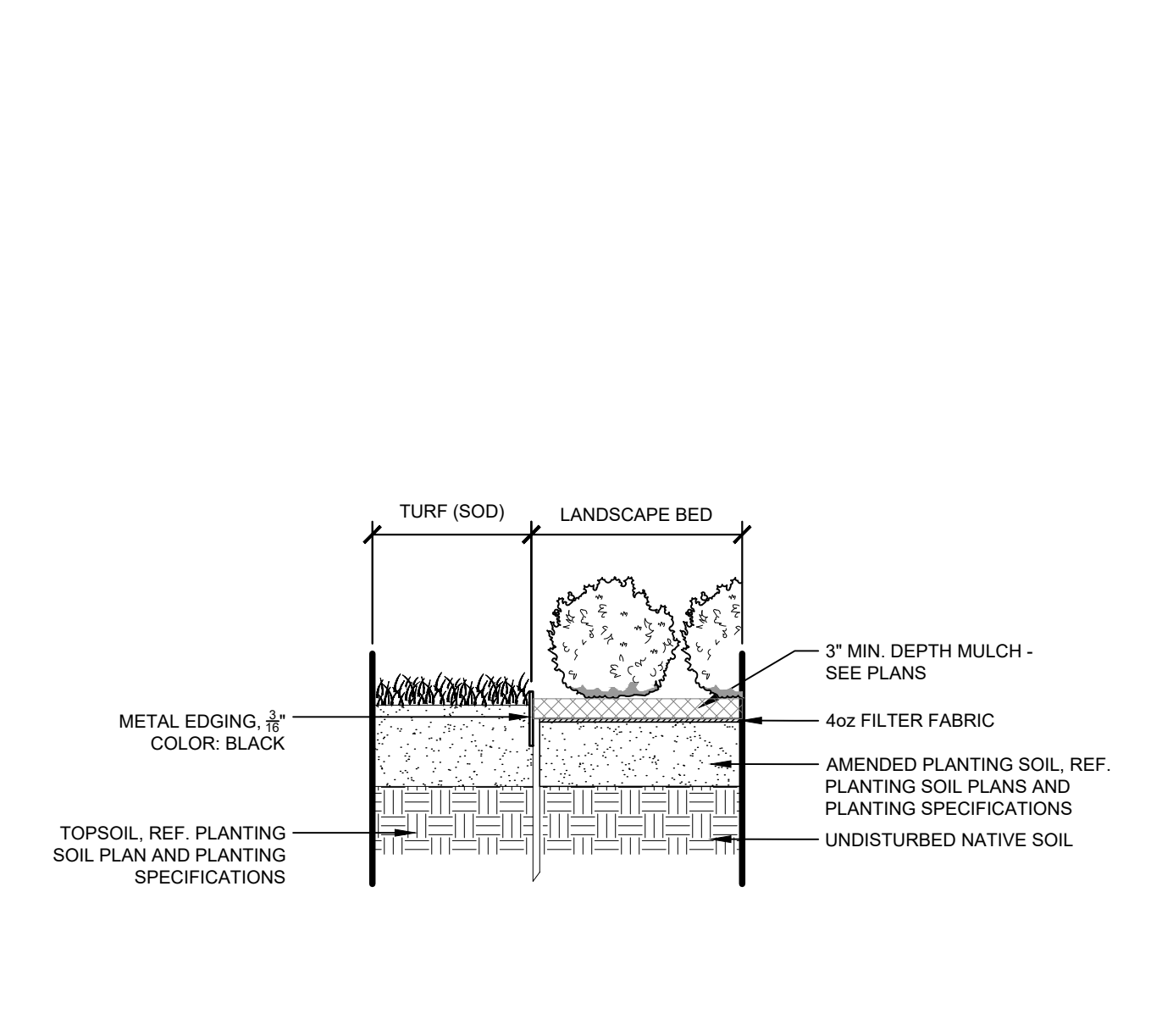

5 METAL EDGER AT PLANTING BED
SECTION / PLAN
1" = 1"
096-523-009-21
NTS

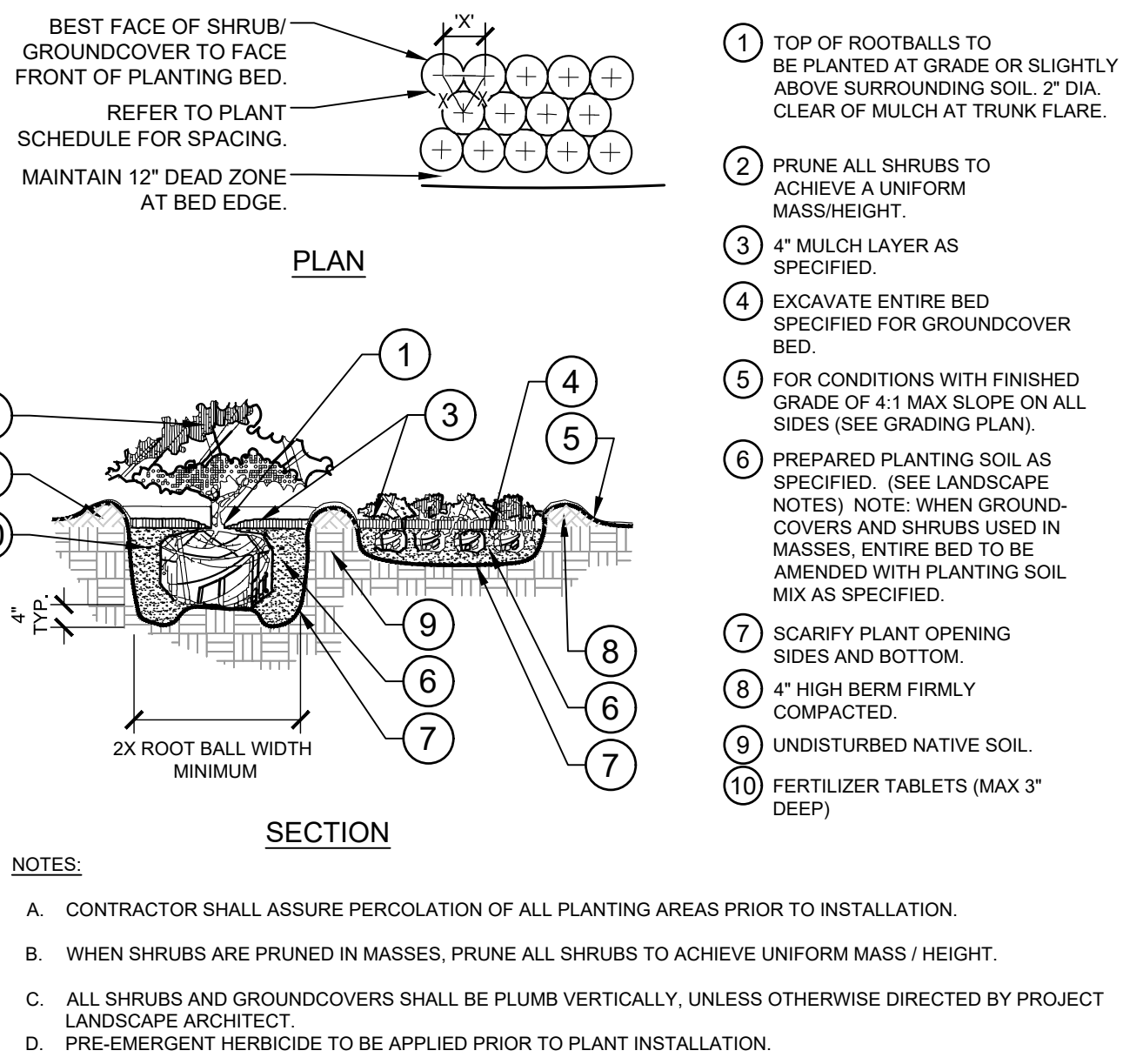

6 SHRUB/GROUNDCOVER PLANTING
SECTION / PLAN
NTS

DETENTION SEED MIX

WATER PLANTAIN	ALISMA SUBCORDATUM
SWAMP MILKWEED	ASCLEPIAS INCARNATA
TICKSEED SUNFLOWER	BIDENS ARISTOSA
ALLEGHENY MONKEYFLOWER	MIMULUS RINGENS
DITCH STONECROP	PENTHORUM SEDOIDES
CUTLEAF CONEFLOWER	RUDBECKIA LACINIATA
COMMON ARROWHEAD	SAGITTARIA LATIFOLIA
BLUE VERVAIN	VERBENA HASTATA
AWL-FRUITED SEDGE	CAREX STIPATA
FOX SEDGE	CAREX VULPINOIDEA
VIRGINIA WILDRIE	ELYMUS VIRGINICUS
SPIKE RUSH	ELEOCHARIS SPECIES
SOFT RUSH	JUNCUS EFFUSUS
PATH RUSH	JUNCUS TENUIS
RICE CUT GRASS	LEERSIA ORYZOIDES
SWITCHGRASS	PANICUM VIRGATUM
SOFTSTEM BULRUSH	SCHOENOPLECTUS TABERNAEMONTANI
PRAIRIE CORDGRASS	SPARTINA PECTINATA

NURSE CROPS:
COMMON OATS
ANNUAL RYE

AVENA SATIVA
LOLIUM MULTIFLORUM

THIS MIX IS COMPOSED OF TENACIOUS SPECIES OF WILDFLOWERS, GRASSES, RUSHES AND SEDGES THAT CAN TOLERATE AREAS THAT ARE INUNDATED PERIODICALLY BY WATER. PRODUCT CODE: DBWT
PLANTING RATE: 35 LBS./ACRE
*MIXTURE MAY VARY OCCASIONALLY FROM THE INDICATED LISTING, BASED ON AVAILABILITY OF INDIVIDUAL SPECIES.
NOTE: POND STABILIZATION TO FOLLOW SECTION 1013.
SEE DETAILS IN ALBUQUERQUE STANDARD SPECIFICATION 1013 FOR SLOPE STABILIZATION AND SEEDING AT DETENTION POND

NATIVE SEED MIX

SANDY SOILS	#PLS/AC
Hilaria jamesii 'Viva' - Galleta	7.0
Oryzopsis hymenoides 'Paloma' - Indian Rice Grass	5.0
Bouteloua gracilis 'Hachita' - Blue Grama	2.0
Bouteloua curtipendula 'Vaughn' - Sideoats Grama	1.0
Agropyron smithii 'Arriba' - Western Wheat	1.0
Sporobolus cryptandrus - Sand Dropseed	1.0
Sporobolus airoides 'Salado' - Alkali Sacaton	1.0
Artemisia frigida - Fringed sagebrush	.25
Sphaeralcea ambigua - Desert Globemallow	.25
Sphaeralcea parvifolia - Nelson Globemallow	.25
Helianthus annuus	.5
Oenothera pallida - White Evening Primrose	.25
Baileya multiradiata - Desert Marigold	.25
Abronia fragrans or Abronia villosa - Sand Verbena	.25

NOTE: POND STABILIZATION TO FOLLOW SECTION 1013.
SEE DETAILS IN ALBUQUERQUE STANDARD SPECIFICATION 1013 FOR SLOPE STABILIZATION AND SEEDING AT DETENTION POND.

SEED RATE IS GIVEN IN POUNDS OF PURE LIVE SEED (PLS) PER ACRE. MIX SHALL INCLUDE AT LEAST FOUR OF THE WILDFLOWER SPECIES LISTED BELOW AT A TOTAL APPLICATION RATE OF AT LEAST 2.0# PLS/AC.

NO.	REVISION	BY	DATE	APPR.

Kimley»Horn
© 2023 KIMLEY-HORN AND ASSOCIATES, INC.
6200 South Syracuse Way, Suite 300
Greenwood Village, Colorado 80111 (303) 228-2300

DESIGNED BY: ECS
DRAWN BY: ECS
CHECKED BY: EIWS
DATE: 4/5/2024

LEGAL DESCRIPTION:
TRACT A, ATRISCO BUSINESS
PARK UNIT 1 CONTAINING
39.775 ACRES

ABB ABQ ADDITION
6625 BLUEWATER ROAD NW
SITE PLAN - DFT
LANDSCAPE DETAILS

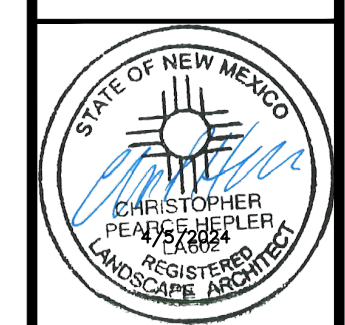

PROJECT NO.
096523009

SHEET
C5.8

THIS DOCUMENT, TOGETHER WITH THE CONTRACTS, AND SPECIFICATIONS PRESENTED HEREIN, IS AN INSTRUMENT OF SERVICE. IT IS INTENDED ONLY FOR THE SPECIFIC PURPOSE AND CLIENT FOR WHICH IT WAS PREPARED. REVIEW OF AND WARRANTY RELIANCE ON THIS DOCUMENT WITHOUT WRITTEN AUTHORIZATION AND AGREEMENT BY KIMLEY-HORN AND ASSOCIATES, INC. SHALL BE WITHOUT LIABILITY TO KIMLEY-HORN AND ASSOCIATES, INC.

PLANT SCHEDULE LANDSCAPE AREA

SYMBOL	CODE	QTY	BUFFER	LANDSCAPE AREA	STREET SCAPE	BOTANICAL NAME	COMMON NAME	CONT	CAL	SIZE
TREES										
	XI	28	2		26	-----	EXISTING TREE TO REMAIN	-		
DECIDUOUS TREES										
	CA2	16		8	8	CRATAEGUS AMBIGUA	RUSSIAN HAWTHORN	B & B	2" CAL MIN	10' - 12' HT. MIN.
	MP	12	1	9	2	MACLURA POMIFERA	OSAGE ORANGE	B & B	2" CAL MIN	10' - 12' HT. MIN.
	PG	14	2	8	4	PROSOPIS GLANDULOSA	HONEY MESQUITE	B & B	2" CAL MIN	10' - 12' HT. MIN.
	QG	13	9	1	3	QUERCUS GAMBELII	GAMBEL OAK	B & B	2" CAL MIN	10' - 12' HT. MIN.
	SD	9	4		5	SAPINDUS DRUMMONDII	WESTERN SOAPBERRY	B & B	2" CAL MIN	10' - 12' HT. MIN.
	UP	13	1	9	3	ULMUS PARVIFOLIA	LACEBARK ELM	B & B	2" CAL MIN	10' - 12' HT. MIN.
EVERGREEN TREES										
	JS	4	4			JUNIPERUS MONOSPERMA	ONESEED JUNIPER	B & B		6' HT MIN
	PN	6	6			PINUS NIGRA	AUSTRIAN PINE	B & B		6' HT MIN
ORNAMENTAL TREES										
	CL	10	6	4		CHILOPSIS LINEARIS	DESERT WILLOW	B & B	2" CAL MIN	10' - 12' HT. MIN.
	CA	10	7	3		CRATAEGUS AMBIGUA	RUSSIAN HAWTHORN	B & B	2" CAL MIN	10' - 12' HT. MIN.
SYMBOL	CODE	QTY	BUFFER	LANDSCAPE AREA	STREET SCAPE	BOTANICAL NAME	COMMON NAME	CONT	SPACING	SIZE
SHRUBS										
	AL	22	22			AMORPHA CANESCENS	LEADPLANT	5 GAL	SEE PLAN	18" FULL
	AW	48	48			ANISACANTHUS WRIGHTII	WRIGHT'S DESERT HONEYSUCKLE	5 GAL	SEE PLAN	18" HT MIN
	AT2	36	36			ARTEMISIA TRIDENTATA	BIG SAGEBRUSH	5 GAL	SEE PLAN	36" FULL
	BM	33	33			BUDDLEJA MARRUBIFOLIA	WOOLY BUTTERFLY BUSH	5 GAL	SEE PLAN	36" FULL
	FP	9			9	FALLUGIA PARADOXA	APACHE PLUME	5 GAL	SEE PLAN	24" FULL
	HP	28	18	10		HESPERALOE PARVIFLORA	RED YUCCA	5 GAL	SEE PLAN	18" FULL
	LS	78	48		30	LEUCOPHYLLUM FRUTESCENS 'COMPACTA'	COMPACT TEXAS RANGER	5 GAL	SEE PLAN	24" HT MIN
ORNAMENTAL GRASSES										
	SW	6			6	SPOROBOLUS WRIGHTII	BIG SACATON	1 GAL		
SYMBOL	CODE	QTY	BUFFER	LANDSCAPE AREA	STREET SCAPE	BOTANICAL NAME	COMMON NAME	CONT		
GROUND COVERS										
	XL2	8,281 SF		8,281 SF		1-4" AGGREGATE MULCH ROCK	1-4" ANGULAR AGGREGATE MULCH	ROCK		
	XT	4,093 SF		4,093 SF		2-4" AGGREGATE MULCH ROCK	2-4" ANGULAR AGGREGATE MULCH	ROCK		
	RM	57,793 SF	9,350 SF	37,750 SF	10,693 SF	3/4"-1" ROCK MULCH	TO MATCH EXISTING	-		
	XL	24,890 SF		24,890 SF		APPLEWOOD NATIVE SEED MIX	NATIVE SEED MIX	SEED		
	XA	8,060 SF		8,060 SF		APPLEWOOD SEED MIX	DETENTION SEED MIX	SEED		

CODE TABLE

LANDSCAPE AREA
TOTAL LOT AREA = 39.94 ACRES / 1,739,791 SF
TOTAL GROSS LOT AREA = 1,739,791 SF
TOTAL BUILDING AREA (EXISTING TO REMAIN) = 103,007 SF
TOTAL BUILDING AREA (PROPOSED) = 89,631 SF
NET LOT AREA = 1,547,153 SF

TOTAL NET LOT AREA = 1,547,153 x 20% = 309,431 SF
TOTAL LANDSCAPE REQUIREMENT = 309,431 SF

EXISTING LANDSCAPE = 285,700 SF
PROPOSED LANDSCAPE = 94,658 SF
TOTAL LANDSCAPE AREA PROVIDED = 380,358 SF (24%)
*NOT COUNTING OVERLAPPING MULCH

EXISTING TREES TO BE REMOVED = 3 TREES
EXISTING TREES TO REMAIN = 28 TREES
PROVIDED SHADE TREES = 77 TREES
PROVIDED ACCENT/ORNAMENTAL TREES = 20 TREES
PROVIDED EVERGREEN TREES = 10 TREES

TOTAL COVERAGE (PROPOSED LANDSCAPE AREA) 94,658 x 75% = 70,993.5 SF
TOTAL COVERAGE REQUIREMENT = 70,933.5 SF
TOTAL COVERAGE PROVIDED = 107,853 SF
COVERAGE OF ROCK MULCH PROVIDED = 63,886.5 SF (66%)
COVERAGE OF GROUND-LEVEL PLANTS REQ. = 23,664.5 SF (25%)
COVERAGE OF GROUND-LEVEL PLANTS PROV. = 38,150 SF (40%)
*CALCULATION ASSUMES 20 SF PER GROUND PLANT AS AN AVERAGE MATURE SPREAD AND CANOPY COVERAGE

14-6-5-6(F) PARKING LOT LANDSCAPING (P)
242 PROPOSED PARKING STALLS
1 TREE EVERY 100'-0" FT OF PARKING
1 TREE / FOR EACH 10 PARKING STALLS REQUIRED = 25 TREES
TOTAL TREES PROVIDED = 27 TREES

14-6-5-6(D) STREET TREE LANDSCAPING (S)
1,118 LF OF STREET FRONTAGE
1 TREE / PER 25 LF OF STREET FRONTAGE REQUIRED = 45 TREES
TOTAL TREES PROVIDED = 21 TREES
EXISTING TREES TO REMAIN = 26 TREES
(8) EXISTING TREES ARE WITHIN 20'-0" LANDSCAPE BUFFER
(18) EXISTING TREES ARE OUTSIDE 20'-0" LANDSCAPE BUFFER

14-6-5-6(E) EDGE BUFFER LANDSCAPING (EB)
819 LF OF PERIMETER
1 TREE / PER 20 LF OF SITE PERIMETER REQUIRED = 41 TREES
5 SHRUBS / PER 20 LF OF SITE PERIMETER REQUIRED = 205 SHRUBS
TOTAL TREES PROVIDED = 41 TREES
TOTAL SHRUBS PROVIDED = 205 SHRUBS

14-6-5-6(C) PEDESTRIAN WALKWAYS (PE)
459 LF OF PEDESTRIAN WALKWAYS
1 TREE / PER 25 LF OF PEDESTRIAN WALKWAY REQUIRED = 19 TREES
TOTAL TREES PROVIDED = 19 TREES

NO.	REVISION	BY	DATE	APPR.

Kimley»Horn
© 2023 KIMLEY-HORN AND ASSOCIATES, INC.
6200 South Syracuse Way, Suite 300
Greenwood Village, Colorado 80111 (303) 228-2300

DESIGNED BY: ECS
DRAWN BY: ECS
CHECKED BY: EIVS
DATE: 4/5/2024

LEGAL DESCRIPTION:
TRACT A, TRISCO BUSINESS
PARK UNIT 1 CONTAINING
39.775 ACRES

ABB ABQ ADDITION
6625 BLUEWATER ROAD NW
SITE PLAN - DFT
LANDSCAPE DETAILS

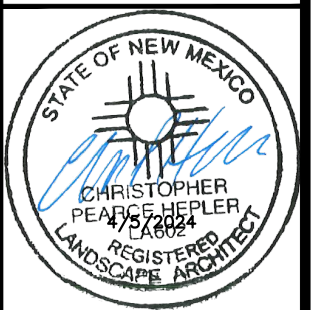

PROJECT NO.
096523009

SHEET

C5.9